

Notes on the Stewardship of Harbor Park by the Trustees

Thanks to Marti Wolfe for researching this issue.

In 2001 (February 5), the Town Attorney (Terry Calderwood) summarized the legal relationship:

“The March 1998 By-laws of the Camden Public Library, in Article I, Section I, sets forth the power, authority, and duty of the Board of Trustees **to manage and control the Camden Public Library, the Amphitheater, Harbor Park, and all things connected therewith.** The By-laws adopted in March 1998 are incorporated into the Public Library Ordinance [Camden town ordinance].

"For that reason, there is no question that the authority to manage and operate the Camden Public Library facilities resides in the Library Board of Trustees.

“The amendment of the By-laws by the Board of Trustees does require confirmation of such an amendment by the Select Board. In addition, the Select Board has the authority to confirm appointments of members of the Board of Trustees.”

- Mary Louise Curtis Bok began accumulating the land for the Library and Harbor Park in 1916, and culminated in the conveyance of the land for Harbor Park to the people of Camden in 1932. From MLCB to Olmsted Brothers, May 3, 1930
- “As you know, my original thought was to clear the shorefront land of ugly buildings, and to open up a view from the harbor of the charming Library, with a green shore front. This I still want done, and I want to put the shore part of it in good condition, following your suggestion of building up the broken wall, strengthening and adding to the present one as you decide is best.”

From MLCB to Camden town manager January 9, 1932

- “I would like to begin to set in motion the **transfer from me to the Town of Camden the Camden shore property**, as I shall be South for the month of February, and I believe the Town Meeting — at which time the transfer should be made — occurs in March. . . . Following acceptance by the Town I will make over Deed covering the transfer, sending same to you for signature.
- “**This conveyance, you will note, follows the form of the rest of the Library lot transfer in that the property, while given to the Town, is to be in control of the Library Trustees. This seems the surest way keeping control of the properties out of politics.**”
- “Article to be inserted in the town Warrant to be acted upon at the next annual town meeting in Camden, March 14, 1932:

“**Voted to accept the conveyance of five parcels of land from Mary Louise Bok located on the shore front in said Camden and bounded on the Southwest by land owned by J. Hugh Montgomery and Ruth M. Perry; on the North by Atlantic Avenue; on the North East by land of Cyrus H.K. Curtis and on the South East by Camden Harbor, upon condition that the same be used for park purposes, and be under the control of the Board of Trustees of the Camden Public Library.**”

1929
"Before"
construction

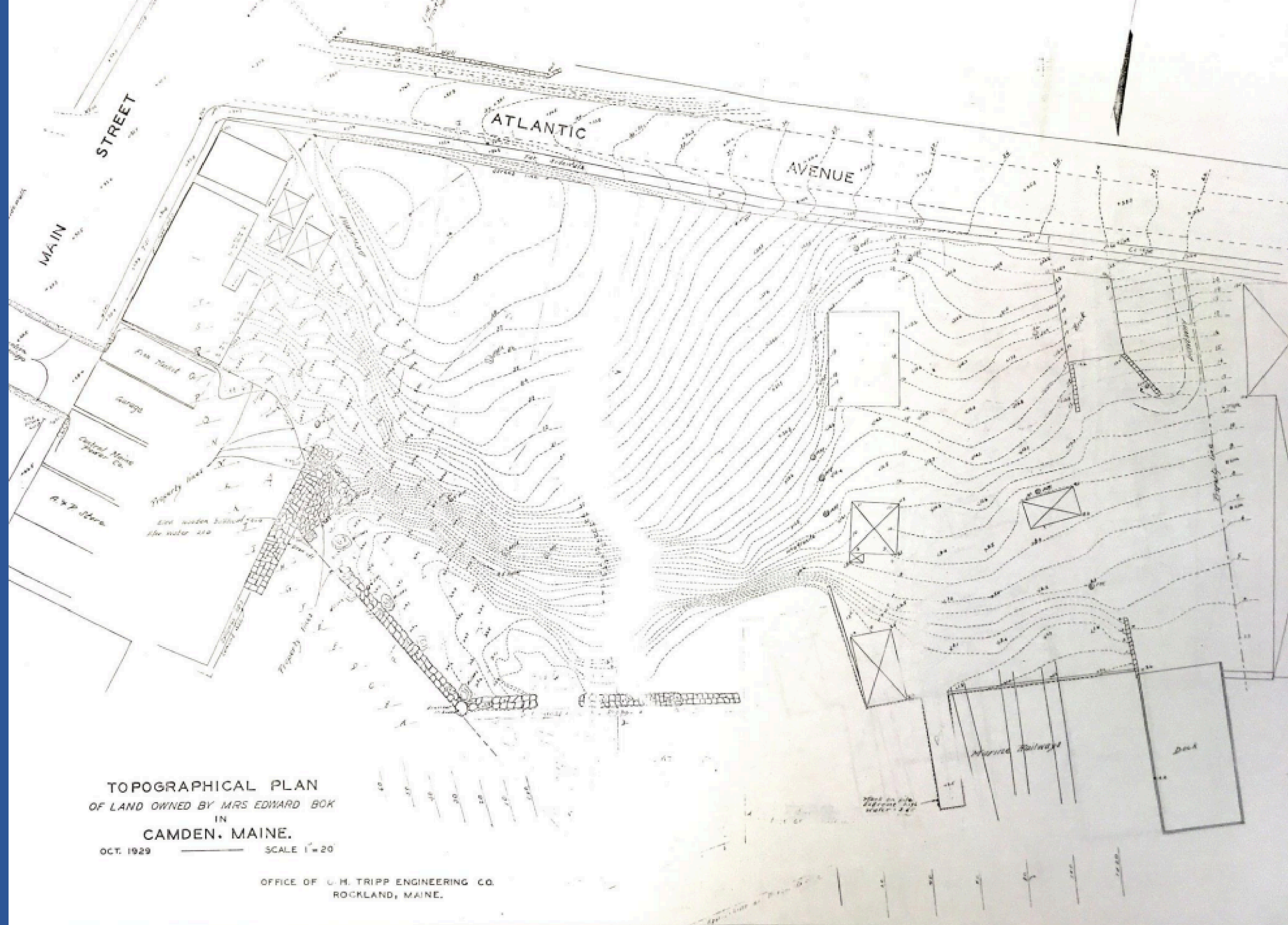

TOPOGRAPHICAL PLAN
OF LAND OWNED BY MRS EDWARD BOK
IN
CAMDEN, MAINE.
OCT. 1929 SCALE 1" = 20'

OFFICE OF C. H. TRIPP ENGINEERING CO.
ROCKLAND, MAINE.

1930 plans

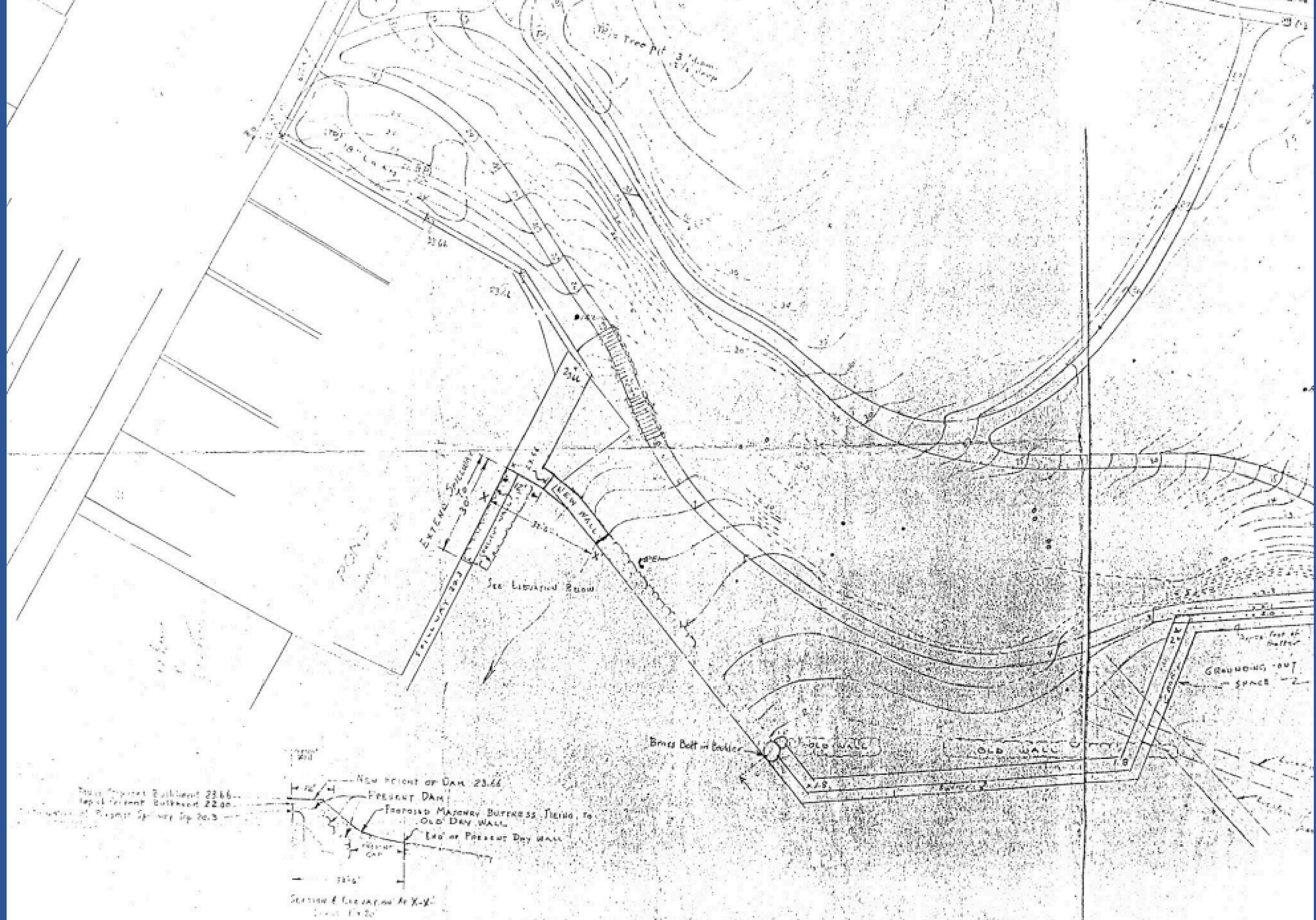

1932 title abstract by Mrs. Bok's agent, Alan Bird:

- “Attention is called to the fact that this is a conditional deed, and should it ever occur that the town used the property in question other than for park purposes, then Mrs. Bok or her heirs or legatees, upon proper notice, could claim the conditions were not fulfilled and the property would revert to her or her heirs or legatees.”

In 1951, MLCB supported the repair and renovation of Harbor Park:

- “Early in 1951, again at the request of Mrs. Zimbalist (MLCBZ), Olmsted Brothers were authorized to consider further improvements along the waterfront of the Park where the initial work had not accomplished all the changes desirable. They proposed that old piers be removed, and the boat house be removed or moved, that a new sea wall be built further back into the Park and that the lawn back of the new wall be remade. Part of the cost would be requested from the Town and eventually this was furnished. The work was done by C. Kendall Hopkins & Son and supervised by Elmer Crockett. It was finished in March 1952 and made a decided improvement in the shore front of the Park.”

SEVEN SHORE FRONT PARK
 CAMDEN, ME.
 THE EXTENSION OF SEA-WALL

SCALE 1" = 40'
 0 20 40 60 80 100
 BROTHERS - LANDSCAPE ARCHITECTS
 BOSTON, MASS. MAR. 2, 1951
 FILE 7317 - NO. 55

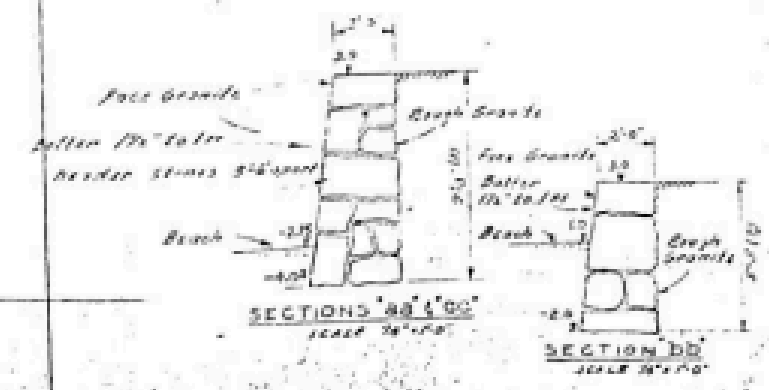
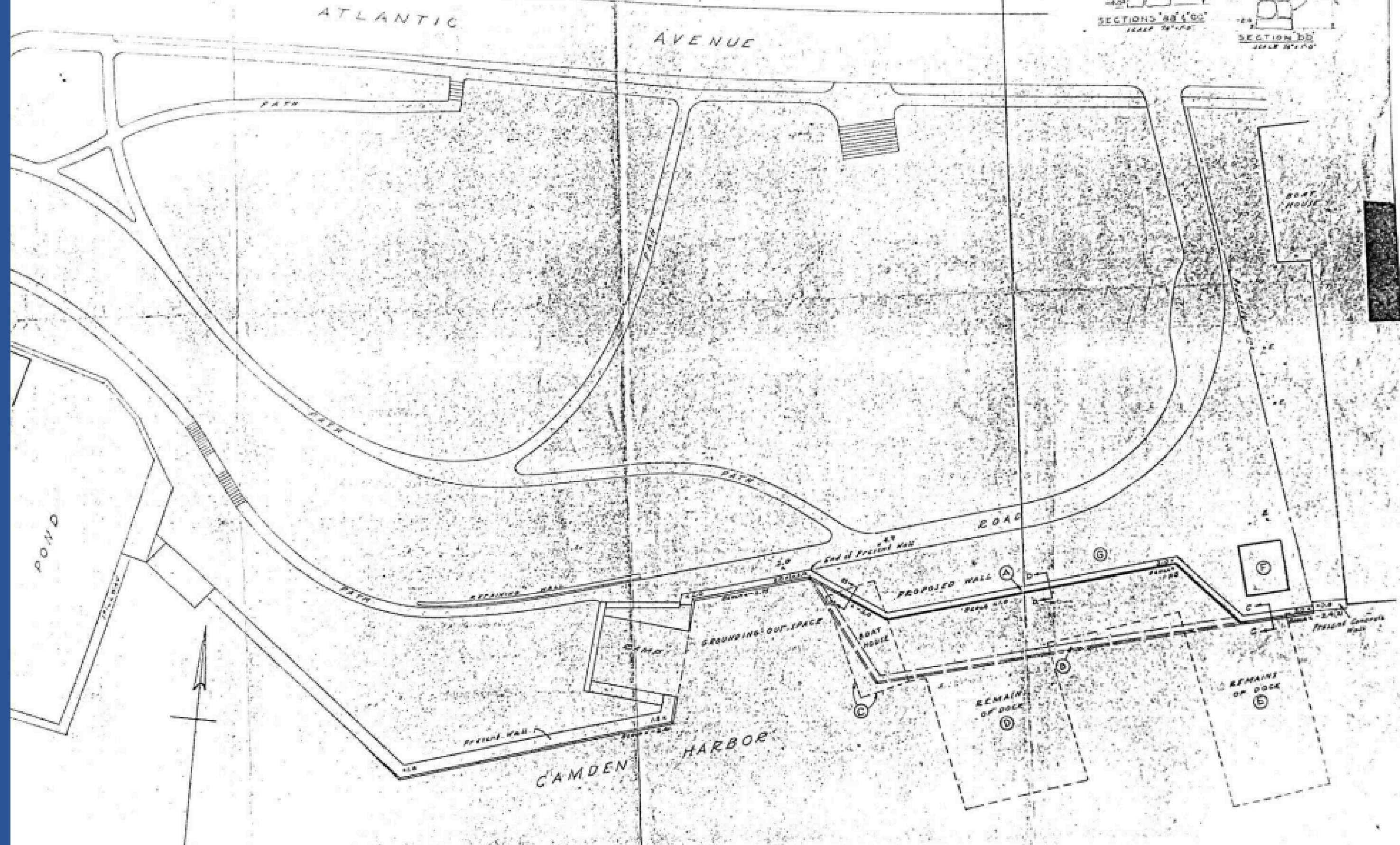

1951
 plans



c. 1940

Harville's Boathouse